



PALCONN TECHNOLOGY

A large, stylized version of the Palconn logo is centered on the page. It features the word "PALCONN" in a bold, grey, sans-serif font, set against a white, irregularly shaped background. This central element is surrounded by a series of concentric, wavy lines in shades of red and orange, creating a sense of depth and movement. The entire design is set against a solid red background with a pattern of thin, wavy lines.

Approvals



Company profile

PALCONN is a leading piping system in developing, producing and exporting all kinds of plastic pipes and fittings in China which can provide integrated system solutions to create comfortable life, work and recreational environment.

We're mainly export PEX pipe, PERT pipe, PPR pipe, PB pipe, EVOH PEX/PERT/PB oxygen barrier pipe, PEX-AL-PEX pipe, PE-AL-PE Gas pipe, drip irrigation pipe, PVC/PP soundproof drainage pipe. Our products are widely used in floor heating, water supply, gas, air-condition, solar, irrigation, drainage system etc.

PALCONN adopts imported high quality material. High quality raw materials preliminary determine the quality of the pipe but strict monitoring quality control system throughout whole procedure from raw material supply to final products manufactured.

With the growing market demand, Palconn all production lines have upgraded to the most advanced high-speed extrusion equipment, whole production lines adopt the imported new generation SIMENS PLC control system to ensure pipe quality and producing efficiency.

We take samples for inspection to check the accuracy of pipe dimension when producing. We print clear marks, date, standard, production code and other specification on pipe for tracking and resourcing.

We also adopts precise automated testing equipment to monitor the producing all the time, strictly guarantee the pipe outside diameter, wall thickness and OOR strictly in the tolerance of standard. The Ultrasonic probe will accurately test the unqualified pipe then cuts it automatically.

All monitoring results must meet ISO9001 standard and be recorded, factory interior implement zero-defect quality management.

There is no doubt we have a complete quality management system so you can trust our pipe quality.

PALCONN pipe has been approved by many third-party of international authoritative organization. Such as NSF, CSA, UPC, WRAS, SAI GLOBAL, TUV Rheinland, Bureau Veritas, INTERTEK, SGS, ANNB, UKAS, CE certificates.

If you need reliable, efficient and high cost performance pipe system, Palconn will be your best choice.



PP Soundproof Drainage System

I .Pipe composition

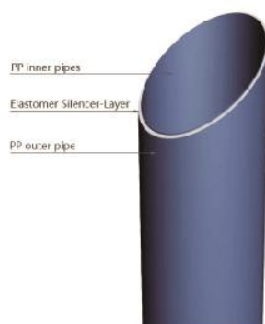

II .Pipe size ranging

Item No.	DN(mm)	EN(mm)
PAL-PP50	50	3.2
PAL-PP75	75	3.8
PAL-PP110	110	4.5
PAL-PP160	160	5.0
PAL-PP200	200	6.5



III .Pipe performance:

Test Item	Unit	Value
Stiffness	KN/m ²	≥ 12
Surface density	g/cm ³	0.95
Limit bending stress	N/mm ²	42.12
Drop hammer impact test TIR	20°C	≤ 10%
Longitudinal retraction rate	%	≤ 3%, no breakage
Joint seal test	No leakage and breakage at the joint	
Oven test	No blistering and cracking	
Elongation at tear(%)	800	
Vicat Softening term.	Below 1kg	≥ 150°C
Noise	dB	40-50

IV .Noise level comparison between pipes

Pipe Name	PVC-U	Cast Iron Pipe	Super soundproof pipe
Material	PVC	Cast iron	Special sound absorbing material
Density(g/cm ³)	1.4	7.8	1.3-1.9
Pipe thickness(mm)	3.2	5.5	4.5
Noise leve(Db)	37	25	17

III .Pipe performance:

Super Silent drainage products has advantages of lightweight,non-toxic,flame retarcant,corrosion resistance, aging resistance and high resistance performance.

5.1. Excellent soundproof performance:by adding special soundproof material to absorb sound waves and prevent sound spread,noise reduction is much better than case iron & UPVC drainage pipe.

5.2. Super anti corrosion:Inner tube can resist acid up to PH2,resist alkali up to PH12

5.3. High temperature resistance:can bare 95°C hot water.

III .Pipe performance:

Can be used to drainage system of:office building,hospital,hotel,residential district,villa,embassy building,hot spring drainage water,etc

III .Pipe performance:

7.1. Drainage water flow impacts pipe wall causing vibration of the pipe.

6.2. Drainage water flow causes the rapid compression of the air arising noise.

6.3. Noise of the drainage water flow.

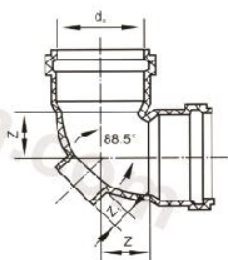

90° Elbow (double flaring w/checking door)

OD(mm)	Z
50	36
110	58

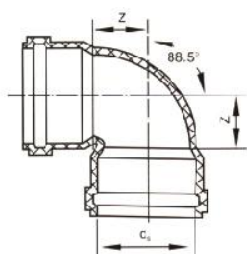

90° Elbow (double flaring)

OD(mm)	Z
75	42
160	88
200	

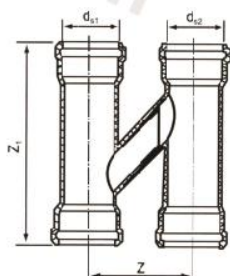

H-shaped Fitting

OD(mm)	OD2(mm)	Z1	Z2
110	75		180
110	110	325	180
160	110	345	180

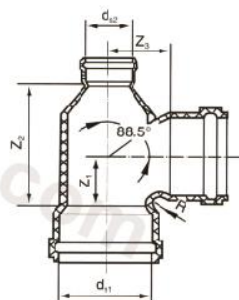

Bottleneck Tee

OD(mm)	Z1	Z2	Z3	R
110x50	62	117	71	30

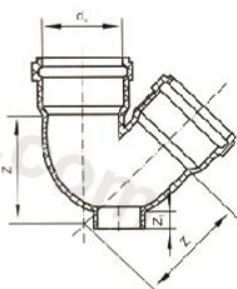

Trap (w/checking door)

OD(mm)	Z	Z
50	60	16
110	140	20

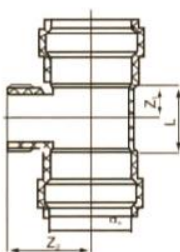

Checking Door (double flaring)

OD(mm)	L	Z1	Z2
160	235	85	108
200			

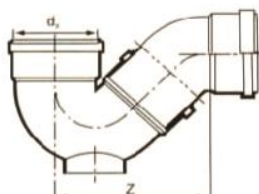

P-shaped Trap

OD(mm)	Z
50	115
110	196

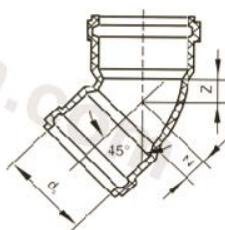

45° Elbow (double flaring)

OD(mm)	Z
75	15
160	33
200	

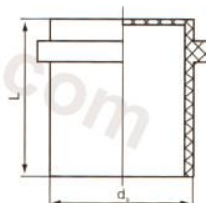

End Cap

OD(mm)	L
50	60
75	63
110	67
160	60
200	

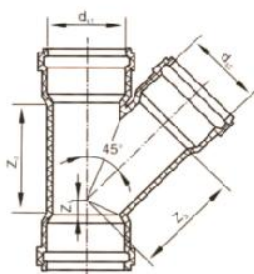

Lateral Tee

OD(mm)	Z1	Z2	Z3
75x50	11	83	80
75x75	15	119	105
110x50	-17	79	109
110x75	-2	125	128
110x110	23	157	134
160x110	0	164	174
200x160			

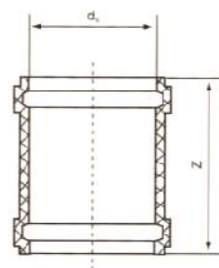

Coupler

OD(mm)	Z
50	106
75	109
110	119
160	150
200	

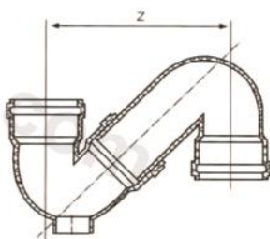

S-shaped Trap

OD(mm)	Central Distance
50	140
110	255

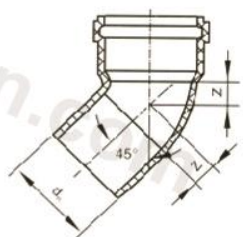

45° Elbow (single flaring)

OD(mm)	Z
50	14
110	25

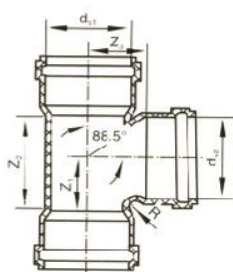

Tee

OD(mm)	Z1	Z2	Z3	R
50x50	33	54	35	15
75x50	34	80	48	20
75x75	45	77	52	20
110x50	32	49	62	30
110x75	43	79	70	30
110x110	63	117	72	30
160x110	66	115	93	30
160x160	89	165	104	35
200x200				

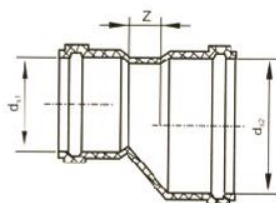

Reducing Coupler

OD(mm)	Z
75x50	20
110x50	39
110x75	26
160x110	57.5
200x160	

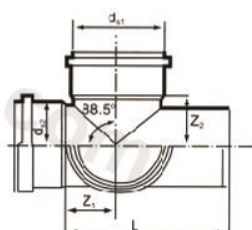

Rectangular Cross

OD(mm)	L (mm)	Z1(mm)	Z2(mm)
110x110	196	66	66
160x110	204	64	92

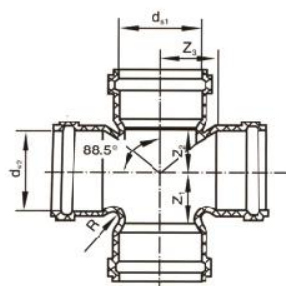

Cross

OD(mm)	Z1	Z2	Z3	R
110x110	64	63	72	30
160x110	61	54	93	30
200x160				

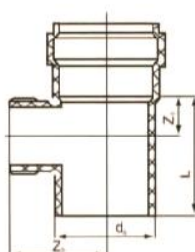

Checking Door (single flaring)

OD(mm)	L	Z1	Z2
75	135	40	58
110	180	58	75

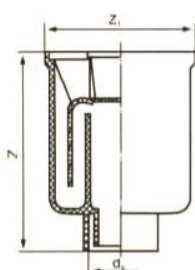

Floor Drain (square)

OD(mm)	Z1	Z2
50	123	102

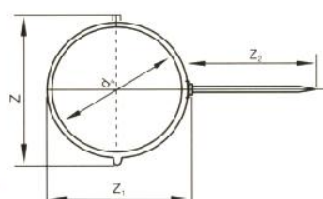

Clamp

OD(mm)	Z1	Z2	Z3
50	82	75	110 150
75	107	100	110 150
110	148	143	110 150
160	205	198	110 150
200			

Installation Instructions



Step1



Step2



Step3



Step4



Step5



WEIFANG PALCONN PLASTICS TECHNOLOGY CO.,LTD

ADD:YINMA INDUSTRIAL ZONE,WEIFANG,SHANDONG,CHINA

ZIP CODE:261317

Tel/Fax:0086-536-8798363

Email: info@palconn.cn

WEB:<http://www.palconn.com>